

Accessories Optional



or



- Built-in cable and plug
- External plug-and-play kit
- Pipe joint (plastic/brass)



**Hydrocall-2200**

**Traditional Controller**

Starting Pressure	<b>0-10bar (adjustable)</b>	1.5bar or 2.2bar
Max Rated Current	<b>10A, from 0.1KW-2.2KW Motor</b>	10A, from 0.37KW-1.1KW Motor
Max Allowable Pressure	<b>15bar</b>	10bar
Rated Voltage	<b>90-260V</b>	110V or 220V
Max Liquid Temperature	<b>80°C</b>	60°C
Waterproof	<b>YES</b>	NO
Energy Saving	<b>Digital Power Chip, very low standby power consumption, less than 5W per day</b>	traditional resistance power, over 30W per day
Heat of Controller	<b>35°C</b>	60°C

# HYDROCALL

## Intelligent Pump Controllers

[www.streampumps.com](http://www.streampumps.com)



HYDROCALL 2200(G)

HYDROCALL 2200(M)

HYDROCALL 2200(AS)

**HYDROCALL series** are electronic automatic controllers designed to control and protect single phase pumps below 2.2kW. They start and stop the pump automatically by opening and closing the water taps, and protect the pump in case of water shortage by preventing it from dry running. Multi-models are under selection for different pumping applications.



TIANJIN ELECMOTOR CO.,LTD  
TIANJIN STREAMPUMPS INDUSTRY CO.,LTD

ADD: No.17, Xeda Jimei Ind. Park Xiqing Economic Development Area, Tianjin, China  
TEL: 0086-22-84180992/3/5 FAX: 0086-22-84180998  
E-mail: sales@streampumps.com



# HYDROCALL

## Intelligent Pump Controllers

### Applications

- High head applications
- Garden and light irrigation
- Tank to tank transfer
- Submersible well pumps



**Hydrocall-2200(M)**

"M" means start pressure can be adjusted manually



**HYDROCALL 2200(G)**

With pressure gauge to read the real-time piping pressure, manually adjustment



**HYDROCALL 2200(AS)**

- Auto-adaptive starting pressure thanks to the design of pressure tank.
- Timing function for scheduled water tower refilling.

### Common Advantages

- Adjustable startup pressure from 0-10bar**
- Easy regulation by control panel**
- Dual control by pressure or flow**
- One controller fits all: supports single-phase pumps up to 2.2kW in different voltage areas with ease.**
- Water shortage protection**
- Low power consumption**
- Automatic restart**
- Water proof circuit board**

### Specifications

- Starting Pressure: **0-10bar (adjustable)**
- Max. Current: **10A**
- Max. Power: **2.2kW**
- Max. Allowable Pressure: **15bar**
- Wide Voltage Range: **90-260V**
- Frequency: **50/60Hz**
- Max. Ambient Temp.: **40°C**
- Max Liquid Temperature: **80°C**
- Protection Degree: **IP65 (PCB with anti-humidity epoxy resin)**
- Joint Screw: **G1" male**

#### Installation Tips

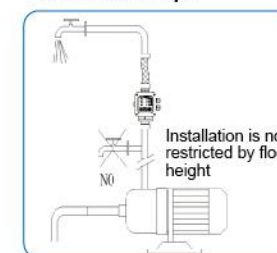

### Working Principle

- The pump starts automatically either by a pressure drop below the starting pressure or by an open flow switch.
- Upon starting, the pump allows for a self-priming time of 3'20" (which can be modified before delivery) to prime itself.
- The pump will automatically stop when the flow switch is closed or in the event of water shortage. Upon water shortage, the pump will continue to run 3'20" before shutting off.
- The starting pressure can be easily adjusted using the + and - buttons to accommodate different working conditions.

### Explosion

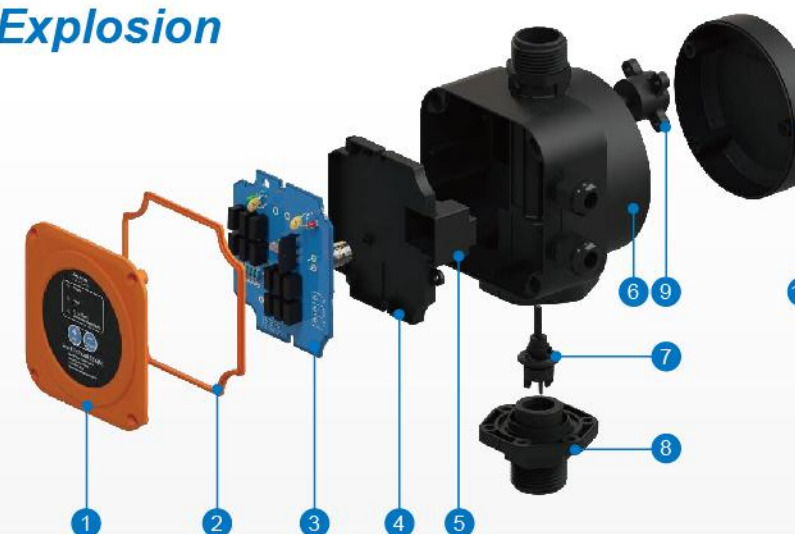

NO.	DESCRIPTION
1	Control panel
2	Seal ring
3	Circuit board
4	Circuit board cover
5	Relay
6	Main body
7	Plunger
8	Threaded joint (inserted flow switch)
9	Pressure transducer
10	Rear cover

### Dimension

Model	Carton Size (LxWxH mm)	CTN (pcs/box)	Master Box Size (LxWxH mm)	N.W. (kg)	G.W. (kg)
HYDROCALL 2200(M)	198x135x112	12	420x410x240	8	10
HYDROCALL 2200(G)	210x168x112	12	520x435x245	9	11
HYDROCALL 2200(AS)	198x135x190	12	420x410x400	15	18

